

Unit B107

Monroe Professional Center Commercial Condominium
[569 usable square feet]

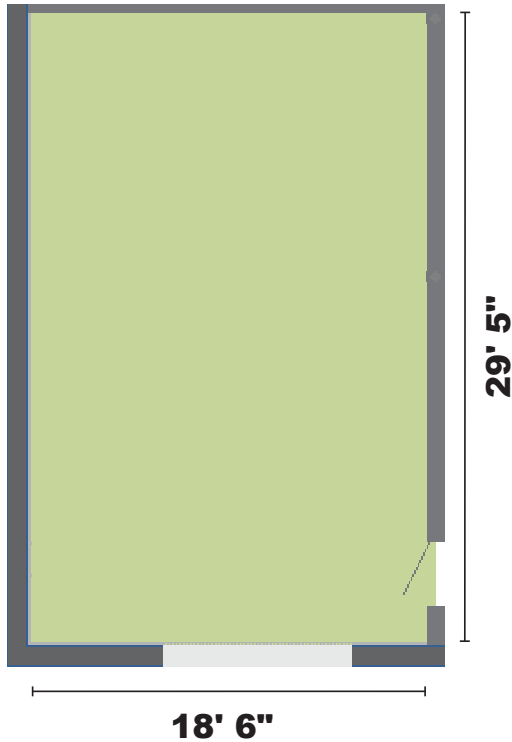

Garage entrance



Additional parking



South project exit



Entrance from hallway

Located in the lowest level of the Monroe Professional Center Condominium, Unit B107 is a large single vehicle garage with room for storage shelving on both sides of a parked vehicle. Vehicle entrance is from the south. The unit has a floor drain and a hose faucet that delivers both hot and cold water.

Unit Information

Usable square feet [BOMA measurement]:	569
Rentable square feet [BOMA measurement]:	622
Real Estate Tax Parcel #:	23 251 0090.0700
2016 Real Estate Taxes:	\$148.70
Condominium Association votes [1000 total]:	11
% ownership of common elements:	1.1
Ceiling height [drywall]:	

Utilities metered to units:

Electricity currently metered to Unit 311

Included condominium services:

Municipal water
Municipal sewer
Solid waste collection
Recyclables collection
Snow removal
Parking [2 lots – 32 stalls]

Unit Address: 1720 10th Street, Monroe, Wisconsin

Unit B107 is owned by Rex A. Ewald and Sharon M. Ewald.

For additional information about this unit check the Monroe Professional Center web site www.mpccondos.com or contact:

Rex A. Ewald
1015 18th Avenue
P.O. Box 56
Monroe, Wisconsin 53566
(608) 329-9610
raewald@voegeli-ewald.com

Last updated December 26, 2016